

# HID-Basic Semi-Parallel ballasts for MHN/CDM lamps

## BMH 070 X261

The HID Basic Semi-Parallel ballast is an impregnated (HID standard) electromagnetic copper/iron ballast for use with an external ignitor for metal-halide and CDM lamps.

### Product data

General Information	
Application Code	70 X261
Lamp Type	MHN-TD/CDM
Number of Lamps	1 piece/unit
Operating and Electrical	
Input Voltage	240 V
Input Frequency	50 Hz
Mains Voltage Performance (AC)	240+6%--8%
Mains Voltage Safety (AC)	240-10%--10%
Input Current with PF Correction	0.41 A
Input Current without PF Correction	1.00 A
Power Factor with PF Compensation	0.85
Power Factor without PF Compensation (Nom)	0.35
Power Losses (Nom)	15 W
Wiring	
Connector Type	Screw

System characteristics	
Rated Ballast-Lamp Power	70 W
Temperature	
T-Winding (Max)	130 °C
Delta-T Normal Conditions	70 °C
Approval and Application	
Energy Efficiency Index	Not specified
Product Data	
Full product code	871150088451000
Order product name	BMH 070 X261
EAN/UPC - Product	8711500884510
Order code	913702251112
Numerator - Quantity Per Pack	1
Numerator - Packs per outer box	12
Material Nr. (12NC)	913702251112
Net Weight (Piece)	1.385 kg

## HID-Basic Semi-Parallel ballasts for MHN/CDM lamps

### Dimensional drawing

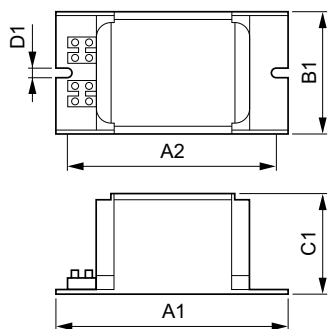

Product	D1	C1	A1	A2	B1
BMH 070 X261	6.3 mm	51.0 mm	117.0 mm	98.0 mm	60.0 mm

BMH 70 X261

